

# The app you're trying to install isn't a Microsoft verified app - windows 11

610 [Frank Mateo](#) Tue, Oct 31, 2023 [Time Software/Systems](#) 0 75394

**AMANO.**

## Introduction

Issue:

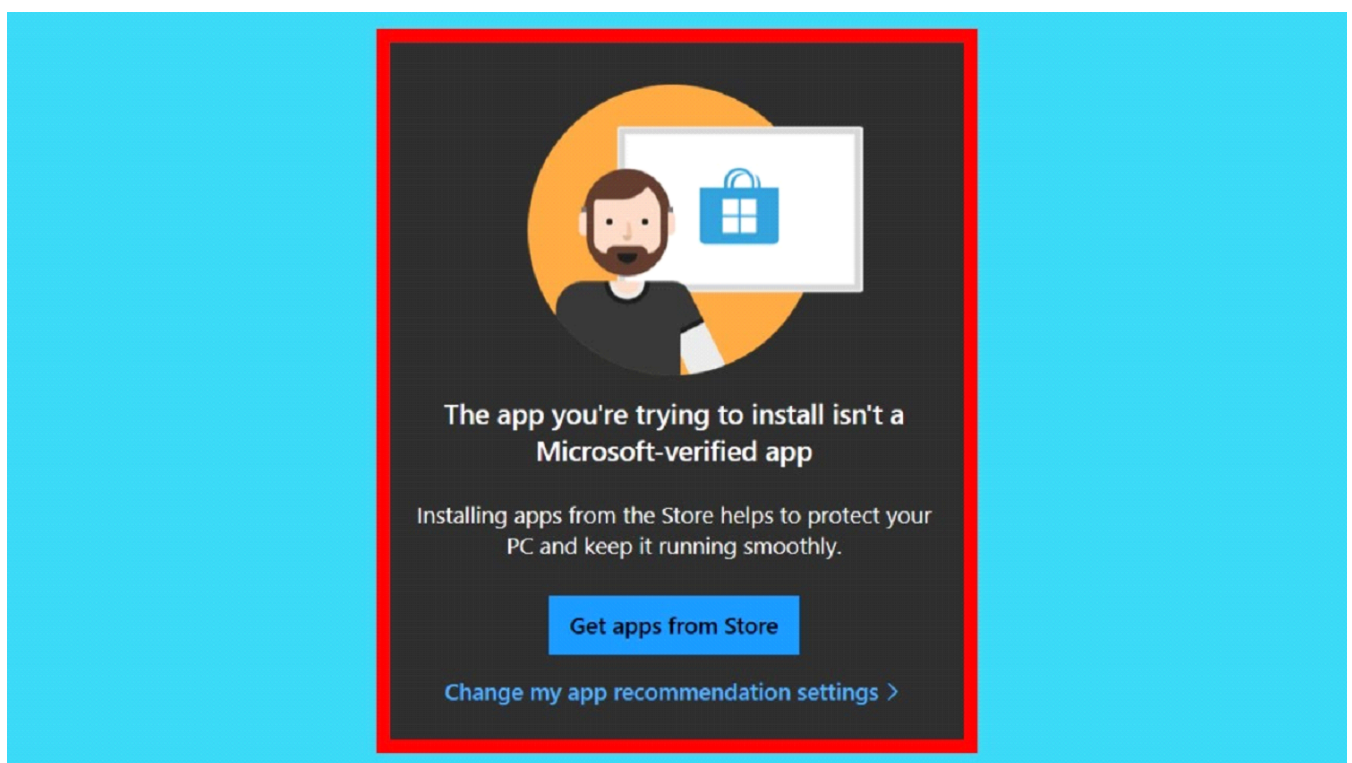

Fix:

1. On your PC running Windows 11 in S mode, open **Settings** ⚙️ > **System** 🖥️ > **Activation**.
2. In the **Switch to Windows 11 Pro** section, select **Go to the Store**. (If you also see an "Upgrade your edition of Windows" section, be careful not to click the "Go to the Store" link that appears there.)
3. On the **Switch out of S mode** (or similar) page that appears in the Microsoft Store, select the **Get** button. After you see a confirmation message on the page, you'll be able to install apps from outside of the Microsoft Store.

Warning- Switching out of S mode can be permanent.

---

## Conclusion

Thank you for your time, and have a great day. As always, feel free to submit ideas on topics you want addressed in the Amano Knowledge Base using the comments feature.

Amano Cincinnati, Inc. reserves the right to make equipment changes and improvements which may not be reflected in this article. Portions of this article may have been updated to include the latest hardware or firmware version, if applicable. Amano assumes no liability for errors and/or omissions. If you should find any errors or unclear information, please notify Amano by posting a comment.

<b>Customer Support Information</b>	Call toll-free in the U.S.: 800-253-9836 (outside U.S. call 973-364-0294) or Fax: 973-364-1091 Mailing address: Amano Cincinnati, Inc., 140 Harrison Ave., Roseland, New Jersey 07068 Web site: <a href="http://www.amano.com/time">www.amano.com/time</a> • E-mail: <a href="mailto:support@amano.com">support@amano.com</a>
---	---

Online URL: <http://tkb.amano.com/article.php?id=610>